

DO NOT SCALE
IF IN DOUBT - ASK!

4 SERIES POLE MOUNTING BRACKET KIT
P/N: 52084

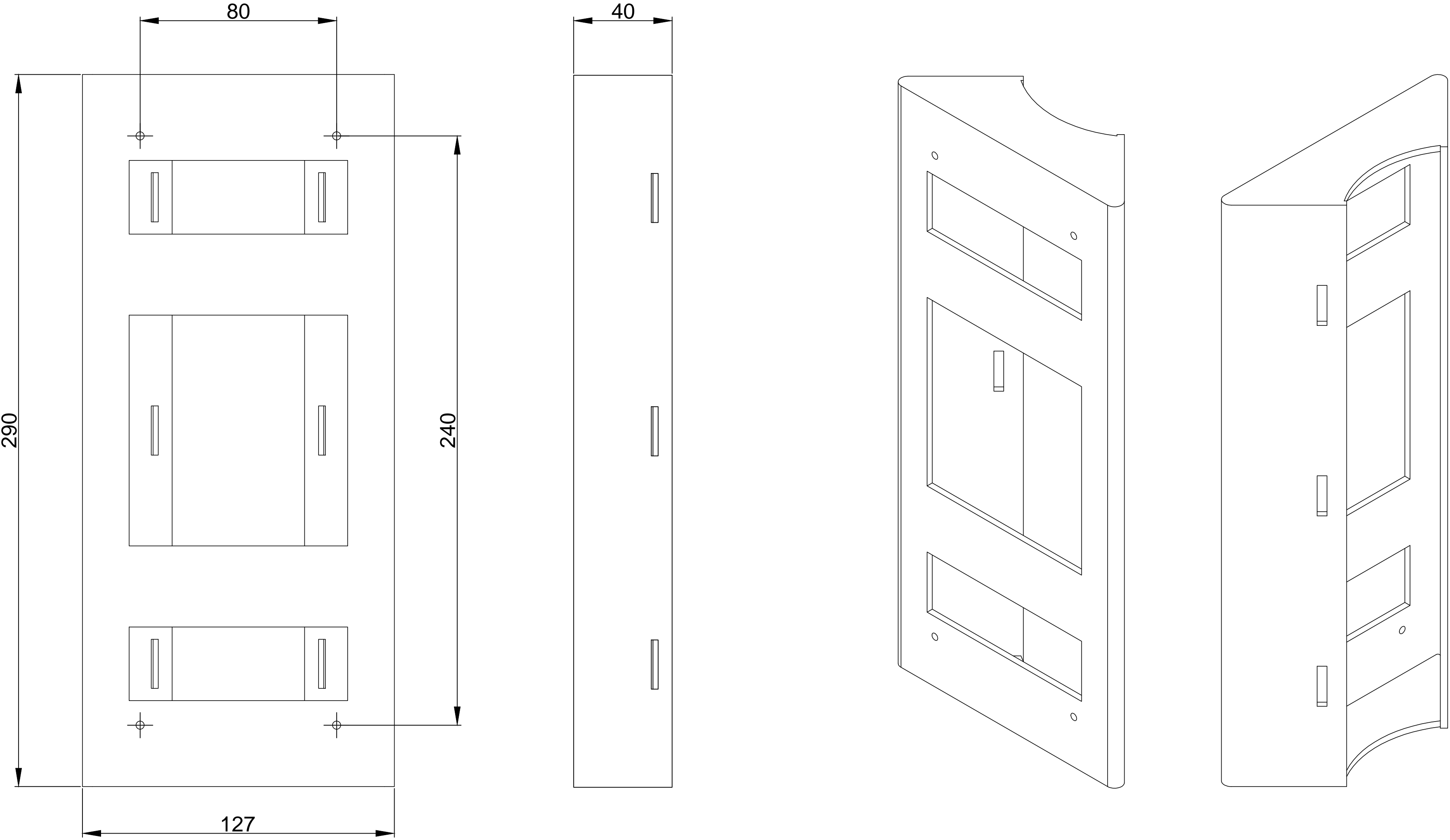

POLE MOUNTING BRACKET MW1544

Pole Mounting Bracket kit (P/N 52084) consists of :

- MW1544 Pole mount bracket
- HW1544 Hi-torque stainless steel hose clamps
- HW1543 Nylon cable gland
- HW988 M4 x 16 mm pan S/S Phil screws
- HW451 M4 nylon washers

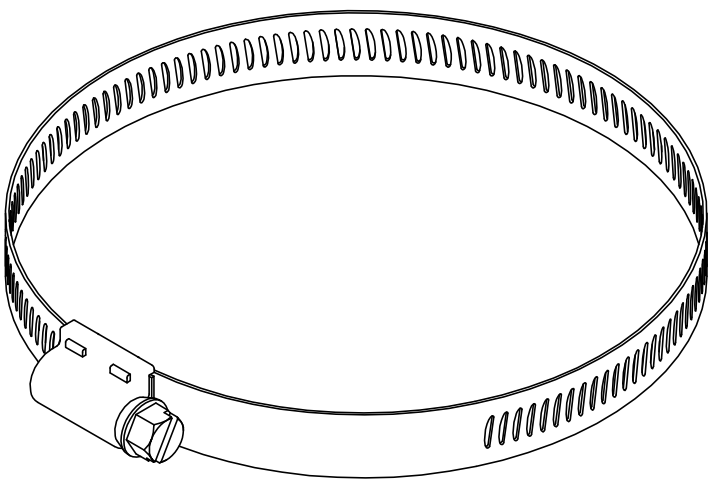

HW1544 Steel hose clamps
(qty 3)

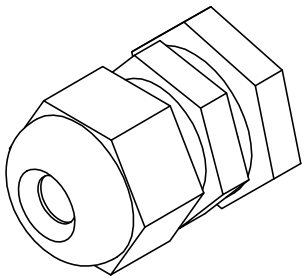

HW1543 Nylon cable gland
(Refer to note 3, sheet 2)

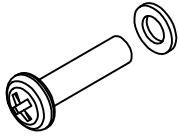

HW988 M4 x 16 mm SS pan head screws
HW451 M4 nylon washers
(qty 4 of each)

Notes:
This drawing is to show the mounting of this bracket to a bollard along with a 4 series backbox, rainhood and VSL-x4x intercom.

REV	DATE	CHANGE DESCRIPTION	BY	<div><div>(C) Copyright Jacques Technologies Pty Ltd. All rights reserved. 28-30 Bank Street, West End Q 4101 Ph: +61 7 3846 8400 www.jacques.com.au info@jacques.com.au</div></div>																												
0	2019-10-22	FIRST RELEASE	HRS																													
				<div><div>4 SERIES POLE MOUNTING BRACKET INSTALLATION</div><table><tr><td>DRAWN:</td><td>DATE:</td><td>ADAPTED FROM:</td><td>FILENAME:</td></tr><tr><td>HRS</td><td>2019-10-22</td><td>N/A</td><td>PMB-410-INS.dwg</td></tr><tr><td>CHECKED:</td><td>DATE:</td><td>SCALE:</td><td>SHEET:</td><td>SIZE:</td></tr><tr><td></td><td></td><td>N.T.S.</td><td>1 of 2</td><td>A1</td></tr><tr><td>APPROVED:</td><td>DATE:</td><td>DWG NO:</td><td colspan="2">REV:</td></tr><tr><td></td><td></td><td>PMB-410-INS</td><td colspan="2">0</td></tr></table></div>	DRAWN:	DATE:	ADAPTED FROM:	FILENAME:	HRS	2019-10-22	N/A	PMB-410-INS.dwg	CHECKED:	DATE:	SCALE:	SHEET:	SIZE:			N.T.S.	1 of 2	A1	APPROVED:	DATE:	DWG NO:	REV:				PMB-410-INS	0	
DRAWN:	DATE:	ADAPTED FROM:	FILENAME:																													
HRS	2019-10-22	N/A	PMB-410-INS.dwg																													
CHECKED:	DATE:	SCALE:	SHEET:	SIZE:																												
		N.T.S.	1 of 2	A1																												
APPROVED:	DATE:	DWG NO:	REV:																													
		PMB-410-INS	0																													

IF IN DOUBT - ASK!

Pole mount bracket

Untermated CAT5e cable

Pole clamps

SWE-1 backbox

Rainhood (optional)

Nylon cable gland (note orientation)

M4 x 16 screws (x4)
M4 nylon washers (X4)
(Part of 52084 kit)

M4 x 30
SS Security screws
(qty 6 supplied with back box)

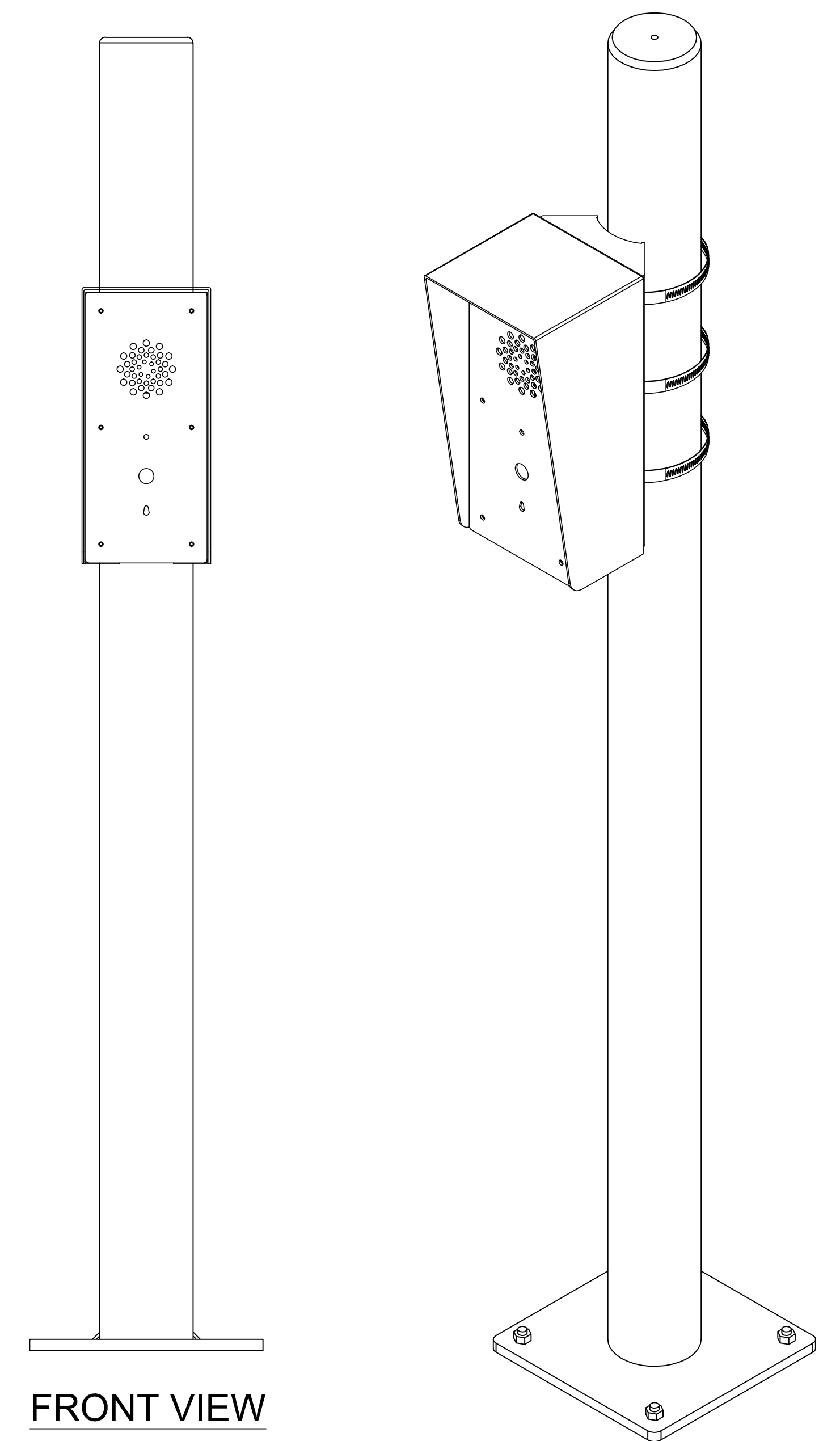

1. Ensure CAT5 cable is available and positioned into the center of the pole mount bracket. Ensure positioning for optimal usage height.
2. Fix bracket to pole with steel pole straps
 - Thread pole clamp strap through bracket slit from the interior. Ensure clamp clasp is positioned off-centre such that the clasp screw is accessible through the front opening of the bracket.
 - Wrap the strap around pole. Thread the strap through second slit and through the clasp.
 - Tighten clasp with screw driver.
 - Repeat for additional straps
 - Excess strap ends may be cut off or folded back out of the way. If cut, ensure that the sharp end is folded back to prevent injury and or cable damage.
3. Fit Cable Gland to Backbox. Note: if using cable gland, CAT5 cable should be unterminated prior to threading cable through gland.
 - Loosen gland lock nut and thread through CAT5 cable
4. Fix Backbox to Bracket
 - Use M4 screws supplied to fix backbox to bracket.
5. Tighten Gland
 - Tighten gland head around CAT5 cable to seal
6. Fix intercom to backbox using M4 x 25 S/S security screws supplied

REV	DATE	CHANGE DESCRIPTION	BY	<div><div>(C) Copyright Jacques Technologies Pty Ltd. All rights reserved. 28-30 Bank Street, West End Q 4101 Ph: +61 7 3846 8400 www.jacques.com.au info@jacques.com.au</div></div> <div>4 SERIES POLE MOUNTING BRACKET INSTALLATION</div> <table><tr><td>DRAWN:</td><td>DATE:</td><td>ADAPTED FROM:</td><td colspan="2">FILENAME:</td></tr><tr><td>HRS</td><td>2019-10-22</td><td>N/A</td><td colspan="2">PMB-410-INS.dwg</td></tr><tr><td>CHECKED:</td><td>DATE:</td><td>SCALE:</td><td>SHEET:</td><td>SIZE:</td></tr><tr><td></td><td></td><td>N.T.S.</td><td>2 of 2</td><td>A1</td></tr><tr><td>APPROVED:</td><td>DATE:</td><td>DWG NO:</td><td colspan="2">REV:</td></tr><tr><td></td><td></td><td>PMB-410-INS</td><td colspan="2">0</td></tr></table>	DRAWN:	DATE:	ADAPTED FROM:	FILENAME:		HRS	2019-10-22	N/A	PMB-410-INS.dwg		CHECKED:	DATE:	SCALE:	SHEET:	SIZE:			N.T.S.	2 of 2	A1	APPROVED:	DATE:	DWG NO:	REV:				PMB-410-INS	0	
DRAWN:	DATE:	ADAPTED FROM:	FILENAME:																															
HRS	2019-10-22	N/A	PMB-410-INS.dwg																															
CHECKED:	DATE:	SCALE:	SHEET:		SIZE:																													
		N.T.S.	2 of 2	A1																														
APPROVED:	DATE:	DWG NO:	REV:																															
		PMB-410-INS	0																															
0	2020-03-02	FIRST RELEASE	HRS																															