

DO NOT SCALE
IF IN DOUBT - ASK!

HPU POLE MOUNTING BRACKET KIT
P/N: 52085

PMP-D10 Pole Mount Bracket (P/N 52085) kit consists of:

- MW1548 HPU Pole mount bracket
- HW1544 Hi-torque stainless steel hose clamps
- HW1543 Nylon cable gland
- HW973 M8 x 20 mm Z/P bolts
- HW098 M8 flat washers Z/P

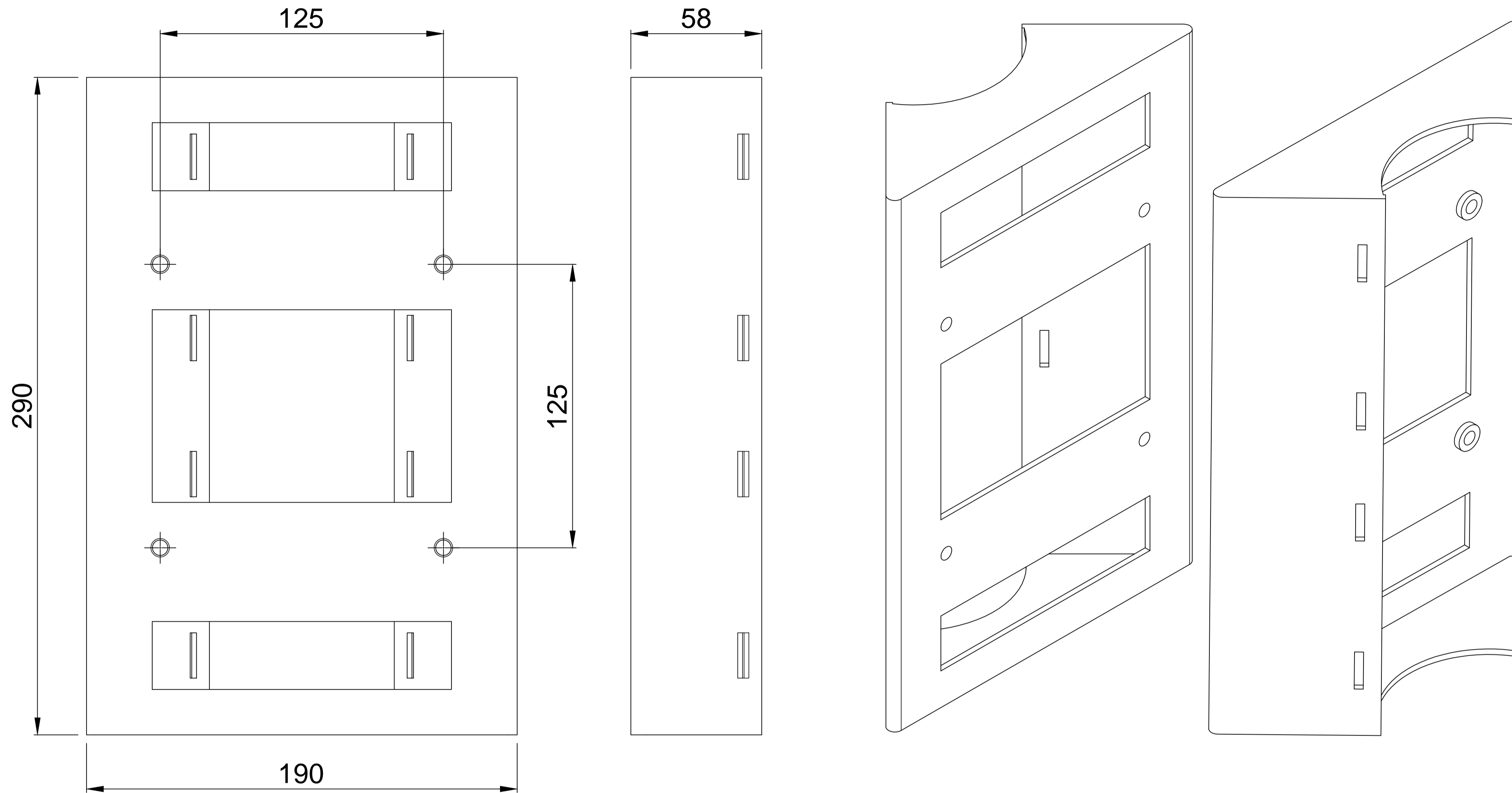

POLE MOUNTING BRACKET MW1548

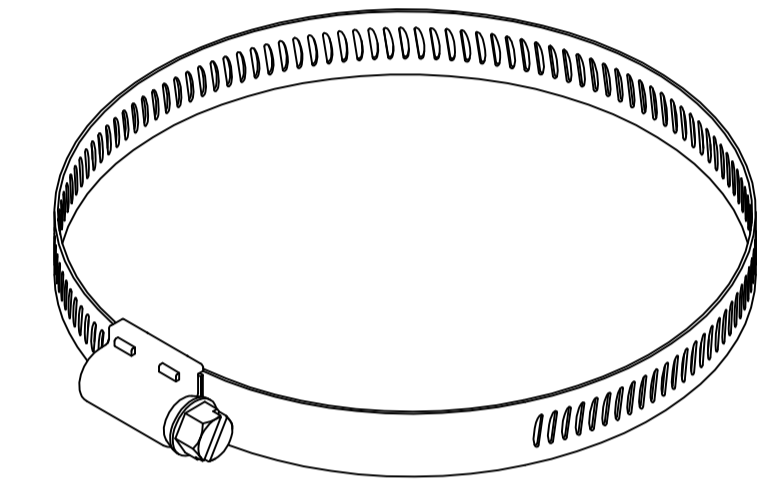

HW1544 Steel hose clamps
(qty 4)

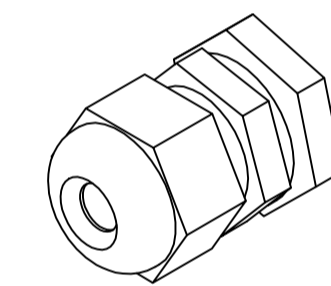

HW1543 Nylon cable gland
(Refer to note 4, sheet 2)

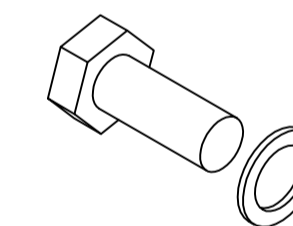

HW973 M8 x 20 mm Z/P bolts
HW098 M8 flat washers Z/P
(qty 4 of each)

Notes:
This drawing is to show the mounting of this bracket to a bollard along with an HPU intercom.

REV	DATE	CHANGE DESCRIPTION	BY
0.1	2019-10-22	FIRST SUBMITTED TO SVN BUT NOT OFFICIALLY RELEASED.	HRS
1	2020-01-30	INITIAL RELEASE. (SIDE VIEW ADDED. 'WORK IN PROGRESS' REMOVED FROM DRAWING.)	LFB

(C) Copyright Jacques Technologies Pty Ltd. All rights reserved.
28-30 Bank Street, West End Q 4101
Ph: +61 7 3846 8400
www.jacques.com.au info@jacques.com.au

HPU POLE MOUNTING BRACKET INSTALLATION			
DRAWN:	DATE:	ADAPTED FROM:	FILENAME:
HRS	2019-10-22	N/A	PMB-D10-INS.dwg
CHECKED:	DATE:	SCALE:	SHEET: SIZE:
		N.T.S.	1 of 2 A1
APPROVED:	DATE:	DWG NO:	REV:
		PMB-D10-INS	1

DO NOT SCALE
IF IN DOUBT - ASK!

HPU POLE MOUNTING BRACKET INSTALLATION DETAILS

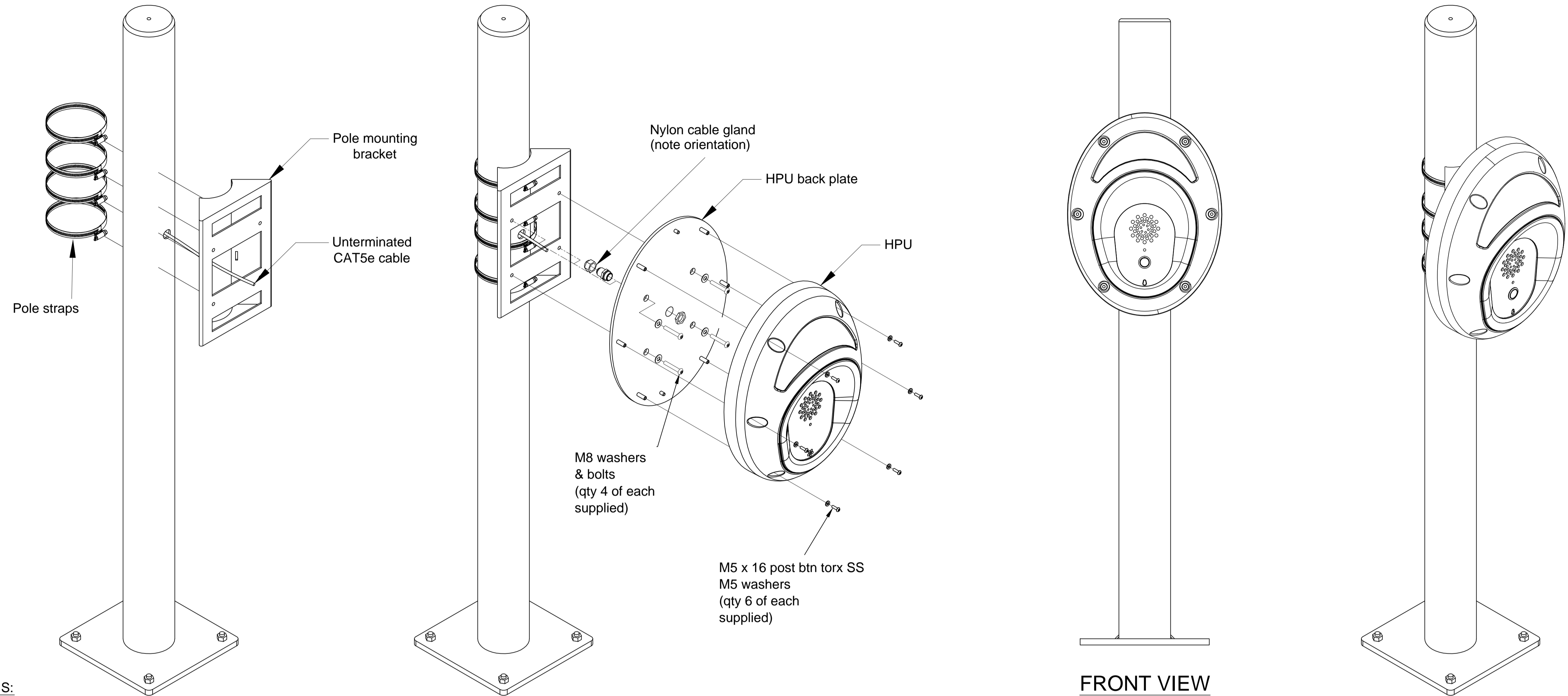

INSTALLATION INSTRUCTIONS:

- Ensure CAT5 cable is available and positioned into the center of the pole mount bracket. Ensure positioning for optimal usage height.
- Fix bracket to pole with steel pole straps:
Thread pole clamp strap through bracket slit from the interior. Ensure clamp clasp is positioned off-centre such that the clasp screw is accessible through the front opening of the bracket. Wrap the strap around pole.
Thread the strap through second slit and through the clasp.
Tighten clasp with screw driver.
Repeat for additional straps
Excess strap ends may be cut off or folded back out of the way.
If cut, ensure sharp end is folded back to prevent injury and or cable damage.
- Fix HPU backing plate to bracket:
The HPU is supplied complete with its rear plate attached.
Remove the 6 x T25 security button head M5 screws from the HPU shell.
There is a short harness wire attachment joining the shell to the backing plate.
Disconnect the harness wire from the shell by removing the Philips pan head M4 screw.
The backing plate is now free to be fixed in place at the installation location.
- Prior to fitting the backing plate to the mounting bracket, fit cable gland.
If using cable gland, CAT5 cable should be unterminated prior to threading cable through the gland.
Fit cable gland to the backing plate of HPU with gland facing the pole bracket.
Loosen gland lock nut and thread through CAT5 cable.
- Fix HPU backing plate to mounted bracket using M8 screws and washers supplied.
- Tighten the CAT5 cable to seal.
- Refit the HPU shell:
Lift shell up, curling the cables safely away from any pinch points and position over the backing plate.
Refit the shell fixing screws

REV	DATE	CHANGE DESCRIPTION	BY
0.1	2019-10-22	FIRST SUBMITTED TO SVN BUT NOT OFFICIALLY RELEASED.	HRS
1	2020-01-30	INITIAL RELEASE. (SIDE VIEW ADDED. 'WORK IN PROGRESS' REMOVED FROM DRAWING.)	LFB

JACQUES
Future Proof Communications
(C) Copyright Jacques Technologies Pty Ltd. All rights reserved.
28-30 Bank Street, West End Q 4101
Ph: +61 7 3846 8400
www.jacques.com.au info@jacques.com.au

HPU POLE MOUNTING BRACKET INSTALLATION			
DRAWN:	DATE:	ADAPTED FROM:	FILENAME:
HRS	2019-10-22	N/A	PMB-D10-INS.dwg
CHECKED:	DATE:	SCALE:	SHEET: SIZE:
		N.T.S.	2 of 2 A1
APPROVED:	DATE:	DWG NO:	REV:
		PMB-D10-INS	1